

WE VALUE



YOUR HOME



Ralegh Crescent, Witney
£1,475 PCM



Available from the end of March 2026 for long term let, un-furnished

Located within the Deer Park Estate, this two-bedroom house features a modern kitchen/breakfast room and contemporary shower room, a lounge and dining room, a low-maintenance rear garden, garage and off-street parking. Situated within 5 minutes of Witney town centre, close to the local primary school and shops and with Burford and Cotswold Wildlife Park just a 10 minute journey!





- AVAILABLE FROM THE END OF MARCH 2026
- LONG TERM LET, UN-FURNISHED
- MODERN KITCHEN/BREAKFAST ROOM
- LOUNGE & DINING ROOM
- LOW MAINTENANCE REAR GARDEN
- STYLISH SHOWER ROOM
- GARAGE & PARKING

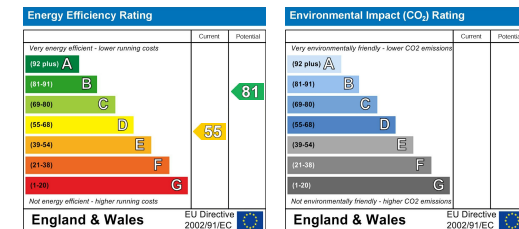

Energy Efficiency Graph

Floor Plan

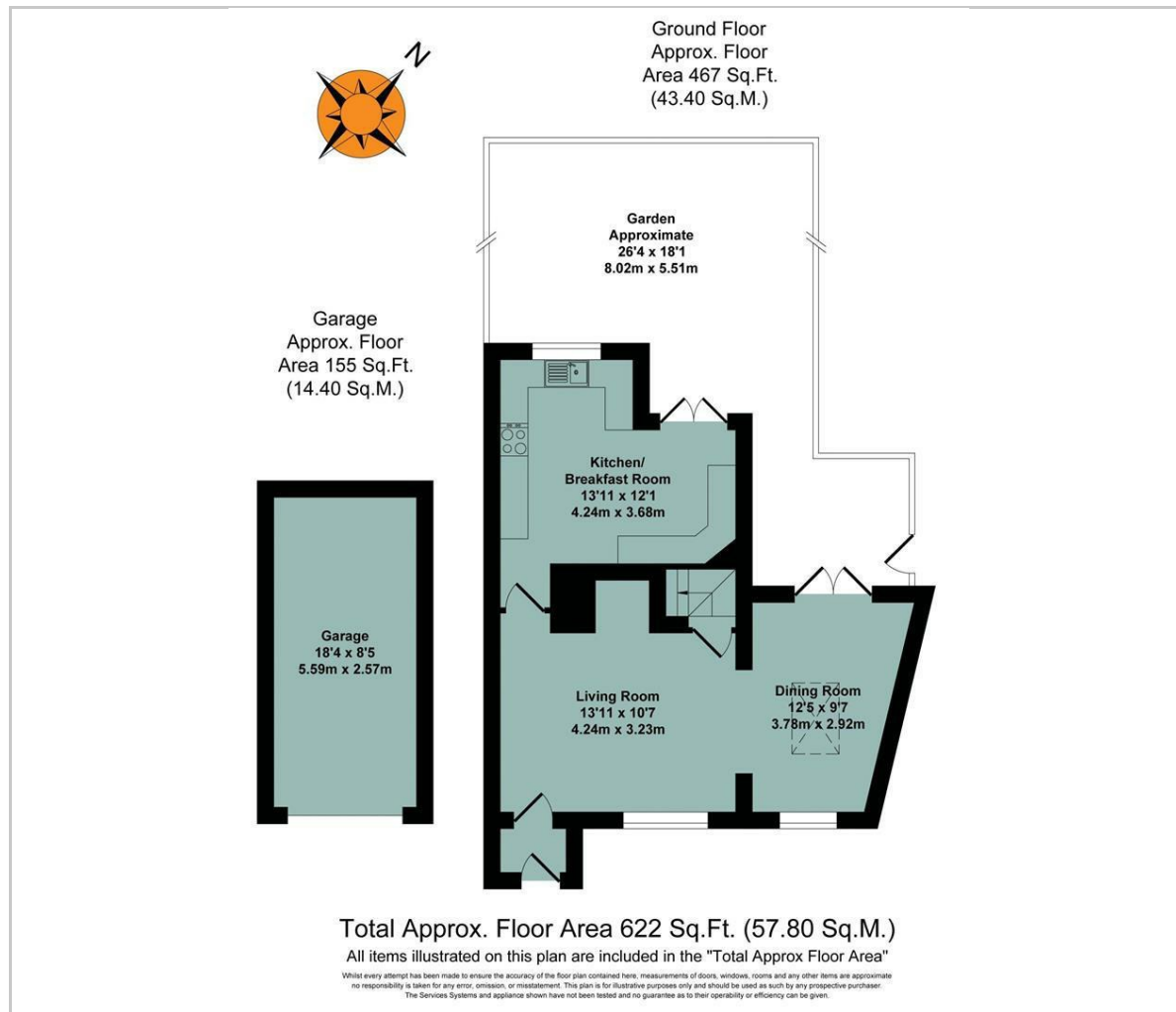

Area Map

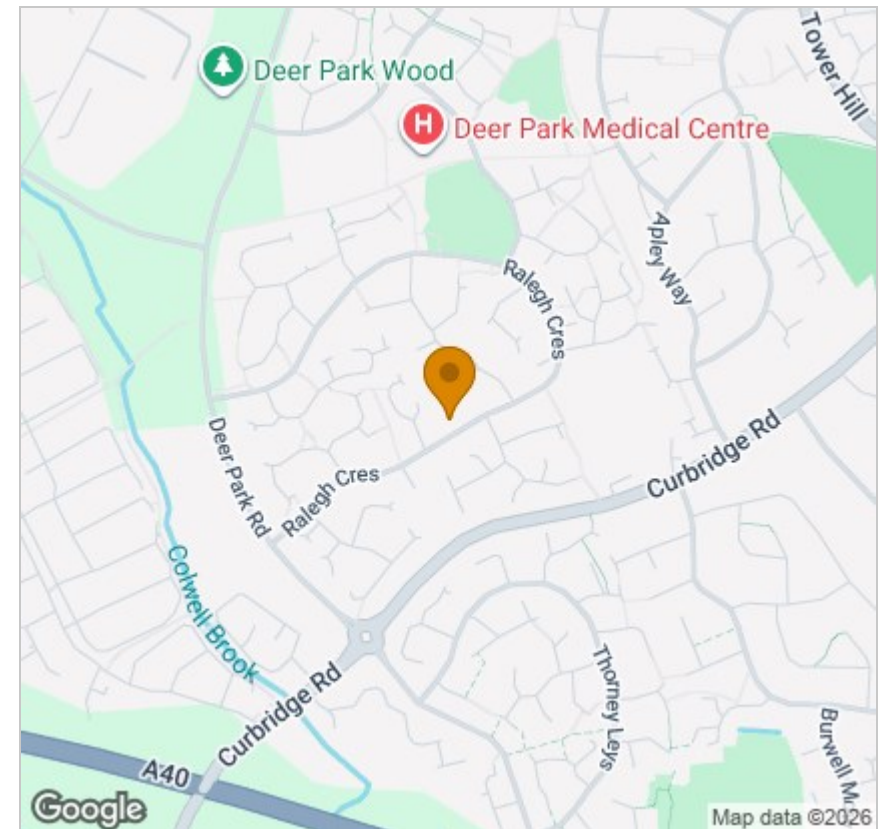

Viewing

Please contact our In House Sales & Lettings Office on 01491 839999 opt.1
if you wish to arrange a viewing appointment for this property or require further information.

These particulars, whilst believed to be accurate are set out as a general outline only for guidance and do not constitute any part of an offer or contract. Intending purchasers should not rely on them as statements of representation of fact, but must satisfy themselves by inspection or otherwise as to their accuracy. No person in this firm's employment has the authority to make or give any representation or warranty in respect of the property.

28 St Martins Street, Wallingford, Oxfordshire, OX10 0AL
Tel: 01491 839999 opt.1 Email: sales@inhouseestateagents.co.uk www.inhouseestateagents.co.uk